

Cover Sleeves

Stainless Steel, EHEDG, 3-A and DGVU Certified, Hygienic Design

SPECIFICATION

Cover sleeve
Stainless Steel AISI 304

Sealing ring

- H-NBR **H**
Temperature resistant -25 °C to +150 °C
- EPDM **E**
Temperature resistant -40 °C to +120 °C
- Blue
- Hardness 85±5 Shore A
- FDA compliant

INFORMATION

Cover sleeves GN 20.1 comply with the guidelines of the EHEDG, the 3-A sanitary standard 88-01 and the DGVU testing principles, making them extremely suitable for use in hygienic areas.

These cover protruding male threads while also substituting for lock nuts. The sealed mounting surfaces enable fastening without dead spaces. The high quality finish prevents adherence of dirt and facilitates cleaning.

ACCESSORY

- Sealing Rings GN 7600 (see page)

TECHNICAL INFORMATION

- Plastic Characteristics (see page A2)
- Stainless Steel Characteristics (see page A26)

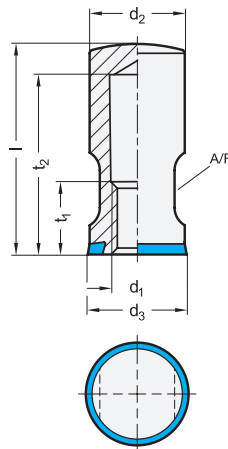

Application example

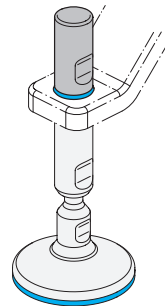

Stainless steel leveling foot GN 20

GN 20.1-H

STAINLESS STEEL

Description	d1	l	d2	d3	A/F	t1	t2	⚖
GN 20.1-M12-56-H	M 12	56	25	25.8	19	15.5	50	159
GN 20.1-M16-62-H	M 16	62	28	28.8	22	20.5	55	200
GN 20.1-M20-68-H	M 20	68	32	32.8	27	25.5	60	272
GN 20.1-M24-74-H	M 24	74	36	36.8	30	30.5	65	352

GN 20.1-E

STAINLESS STEEL

Description	d1	l	d2	d3	A/F	t1	t2	⚖
GN 20.1-M12-56-E	M 12	56	25	25.8	19	15.5	50	159
GN 20.1-M16-62-E	M 16	62	28	28.8	22	20.5	55	200
GN 20.1-M20-68-E	M 20	68	32	32.8	27	25.5	60	272
GN 20.1-M24-74-E	M 24	74	36	36.8	30	30.5	65	352